

NOTICE!!

These documents have been scanned!

Do not place un-scanned documents beneath this notice!

Do not remove this notice from this file!

GPO Jacket No. 560-102
Print Order 61540
Rise Business Services, LLC
Job=AZ15 4/26/2019



Box Number= AZ15003



Claim Begin-End: AMC449125-AMC449128

1 Initial Receipt



AZ15003-43

AMC450400-AMC453366

United States Department of the Interior
Bureau of Land Management
 DIV OF LANDS, MINRLS & ENERGY
 ONE N CENTRAL AVE
 PHOENIX, AZ 85004 -4427
 Phone: 602-417-9200

Receipt

No:

4093365

Transaction #: 4205649

Date of Transaction: 02/22/2018

CUSTOMER:

KELLEY SMELSER
 3922 MARK TWAIN DR
 PINETOP, AZ 85935-8631 US

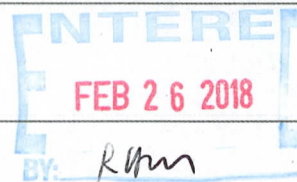

LINE #	QTY	DESCRIPTION	REMARKS	UNIT PRICE	TOTAL
1	4.00	LOCATABLE MINERALS / MINING CLAIMS-NEW, UNADJUD, ONE OR MORE AUTH NOS / NEW MINING CLAIMS LOCATION FEE CASES: AMC449125/\$37.00, AMC449126/\$37.00, AMC449127/\$37.00, AMC449128/\$37.00		- n/a -	148.00
2	4.00	LOCATABLE MINERALS / MINING CLAIMS-NEW, UNADJUD, ONE OR MORE AUTH NOS / NEW MINING CLAIM PROCESSING FEE CASES: AMC449125/\$20.00, AMC449126/\$20.00, AMC449127/\$20.00, AMC449128/\$20.00		- n/a -	80.00
3	4.00	LOCATABLE MINERALS / MINING CLAIMS-NEW, UNADJUD, ONE OR MORE AUTH NOS / NEW MINING CLAIMS MAINTENANCE FEE CASES: AMC449125/\$155.00, AMC449126/\$155.00, AMC449127/\$155.00, AMC449128/\$155.00		- n/a -	620.00
TOTAL:					\$848.00

PAYMENT INFORMATION

NOTE: Items will appear on credit card statement as "Bureau of Land Mgmt CO".

1	AMOUNT:	848.00	POSTMARKED:	N/A
	TYPE:	CREDIT CARD	RECEIVED:	02/22/2018
	NAME:	SMELSER, KELLEY 3922 MARK TWAIN DR PINETOP AZ 85935-8631 US		
	CARD NO:	XXXXXXXXXXXX7880	AUTH CODE:	073211
	NAME ON CARD:	KELLEY R SMELSER		

EXPIRES:	11/2020
SIGNATURE:	

REMARKS

This receipt was generated by the automated BLM Collections and Billing System and is a paper representation of a portion of the official electronic record contained therein.

NOTICE!!

These documents have been scanned!

Do not place un-scanned documents beneath this notice!

Do not remove this notice from this file!

GPO Jacket No. 560-102
Print Order 61540
Rise Business Services, LLC
Job=AZ15 4/26/2019



Box Number= AZ15003



Claim Begin-End: AMC449125-AMC449128

2 Correspondence



AZ15003-43

AMC450400-AMC453366



United States Department of the Interior

BUREAU OF LAND MANAGEMENT

Arizona State Office

One North Central Avenue, Suite 800

Phoenix, Arizona 85004-4427

www.blm.gov/az/

MAR 20 2018



In Reply Refer To:

3800 (9200) RM

AMC449125

CERTIFIED MAIL - RETURN RECEIPT REQUESTED No. 9214 8901 9403 8304 9686 88

NOTICE

KELLEY SMELSER
3922 MARK TWAIN DR
PINETOP, AZ 85935-8631

:
:
:

This Notice Affects the Claims
Shown in the Block Below.

AMC449128
FORTITUDE #5

Mining Claim Location Notices – Corrections Required

Pursuant to Title 43 Code of Federal Regulations (CFR) 3832.1, this office received your notice(s) of location for recordation of mining claims. In accordance with 43 CFR 3832.11 and 3832.12, the claim(s) listed above are not properly located. Because they are not properly located we cannot record them as filed. They must be corrected as noted below or they will be declared null and void.

No location date was provided.

You must provide the requested information for each claim listed above to correct the defects. Please do this by providing a copy of your location notice with the appropriate corrections, and note at the top of the form that it is a "Corrected Copy of Location Notice". If it is only the map that is missing or needs to be corrected, please provide the map. If the information is not received within the 30-day timeframe, the mining claims will be declared null and void ab initio.

If additional information is required, please contact RéAnn Myers at 602-417-9413. Please include your AMC serial number(s) on all correspondence.

A handwritten signature in black ink, appearing to read "Lucas Lucero". The signature is fluid and cursive, with the first name "Lucas" and last name "Lucero" clearly distinguishable.

Lucas Lucero
Deputy State Director
Lands, Minerals and Energy Division



Date Produced: 04/09/2018

ConnectSuite Inc.:

The following is the delivery information for Certified Mail™/RRE item number 9214 8901 9403 8304 9686 88. Our records indicate that this item was delivered on 04/06/2018 at 10:06 a.m. in PINETOP, AZ 85935. The scanned image of the recipient information is provided below.

Signature of Recipient :

A handwritten signature in black ink, appearing to read "Kelly Ann", with a stylized flourish at the end.

Address of Recipient :

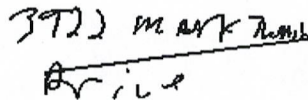
A handwritten address in black ink, reading "3922 MARK Avenue" on the first line and "Avila" on the second line.

Thank you for selecting the Postal Service for your mailing needs. If you require additional assistance, please contact your local post office or Postal Service representative.

Sincerely,
United States Postal Service

The customer reference number shown below is not validated or endorsed by the United States Postal Service. It is solely for customer use.

Customer Reference Number: C737649.4444256

NOTICE!!

These documents have been scanned!

Do not place un-scanned documents beneath this notice!

Do not remove this notice from this file!

GPO Jacket No. 560-102
Print Order 61540
Rise Business Services, LLC
Job=AZ15 4/26/2019



Box Number= AZ15003



Claim Begin-End: AMC449125-AMC449128

3 Transfers



AZ15003-43

AMC450400-AMC453366

**NO
DOCUMENTS
FOUND**

NO DOCUMENTS FOUND
NO DOCUMENTS FOUND

NOTICE!!

These documents have been scanned!

Do not place un-scanned documents beneath this notice!

Do not remove this notice from this file!

GPO Jacket No. 560-102
Print Order 61540
Rise Business Services, LLC
Job=AZ15 4/26/2019



Box Number= AZ15003



Claim Begin-End: AMC449125-AMC449128

4 Annual Filings



AZ15003-43

AMC450400-AMC453366

335

MAINTENANCE FEE WAIVER CERTIFICATION

SC 449125
449281
FORM APPROVED
OMB NO. 1004-0114
Expires: January 31, 2020

SEE INSTRUCTIONS ON PAGE 2

1. This small miner waiver is filed for the assessment year beginning on September 1, 2018 and ending on September 1, 2019.
2. The undersigned and all related parties owned ten or fewer mining claims, mill, or tunnel sites located and maintained on Federal lands in the United States of America on September 1, 2018.
3. The undersigned have performed the assessment work required by law for each mining claim listed prior to filing this waiver and understand that by filing this form, the undersigned must file an affidavit of assessment work with the Bureau of Land Management (BLM) by the December 30th following the filing of this waiver.
4. The undersigned understand that if the assessment work obligation has not yet come due under 30 U.S.C. 28 (for those claims in their first assessment year only), a notice of intent to hold reciting this condition must be recorded by the December 30th following the filing of this waiver.
5. The undersigned understand that mill and tunnel sites may also be listed on this waiver and be waived from payment of the maintenance fee, and that a notice of intent to hold for these sites is required to be filed with the BLM by the December 30th following the filing of this waiver.
6. The undersigned understand and acknowledge that pursuant to 43 U.S.C. 1212 and 18 U.S.C. 1001, the filing or recording of a false, fictitious, or fraudulent document with the BLM may result in a fine of up to \$250,000, a prison term not to exceed five years, or both.
7. The mining claims, mill or tunnel sites for which this waiver from payment of the maintenance fees is requested are:

CLAIM OR SITE NAME	BLM RECORDATION SERIAL NUMBER
1. Fortitude # 1	Amc 449125 (913)
2. Fortitude # 2	Amc 449126
3. Fortitude # 4	Amc 449127
4. Fortitude # 5	Amc 449128
5. Fortitude # 6	Amc 449281
6. Fortitude # 7	Amc 449282
7.	
8.	
9.	
10.	

The owner(s) (claimants) of the above mining claims and sites are:

Kelley Smelser
(Owner's Name - Please Print)
3922 Mark Twain Drive
(Owner's Mailing Address)

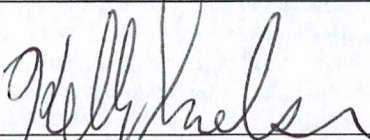
(Owner's Signature)
Pinetop
(City)
AZ
(State)
85935
(Zip Code)

(Owner's Name - Please Print)

(Owner's Signature)

(Owner's Mailing Address)

(City)

(State)

(Zip Code)

(Owner's Name - Please Print)

(Owner's Signature)

(Owner's Mailing Address)

(City)

(State)

(Zip Code)

(Owner's Name - Please Print)

(Owner's Signature)

(Owner's Mailing Address)

(City)

(State)

(Zip Code)

(Continued on page 2)

ENTERED
SEP 12 2018
BY: BOS

RECEIVED
M AZ STATE OFFICE
2018 AUG 23 4:32
PHOENIX, ARIZONA

(Owner's Name - Please Print)

(Owner's Signature)

(Owner's Mailing Address)

(City)

(State)

(Zip Code)

(Owner's Name - Please Print)

(Owner's Signature)

(Owner's Mailing Address)

(City)

(State)

(Zip Code)

(Owner's Name - Please Print)

(Owner's Signature)

(Owner's Mailing Address)

(City)

(State)

(Zip Code)

(Owner's Name - Please Print)

(Owner's Signature)

(Owner's Mailing Address)

(City)

(State)

(Zip Code)

18 U.S.C. 1001 and 43 U.S.C. 1212 make it a crime for any person knowingly and willfully to make to any department or agency of the United States any false, fictitious or fraudulent statements or representations as to any matter within its jurisdiction.

INSTRUCTIONS

1. This certification is made under the provisions of 43 U.S.C. § 1744 and 30 U.S.C. §28-28k and the regulations thereunder (43 CFR Part 3830).
2. The claimant(s) must fill in the dates in paragraph 1 for the beginning and ending of the assessment year for which this waiver is sought.
3. The claimant(s) must fill in the date in paragraph 2 for the beginning of the assessment year for which this waiver is sought.
4. All claim and site names and BLM serial numbers must be listed for the mining claims, mill sites, and tunnel sites for which the waiver is sought.
5. All owners of the mining claims, mill sites, and tunnel sites and their addresses must be given.
6. This waiver form must be signed by all the claimants or their designated agent, in original form. If an agent is designated, a notarized designation of agent, signed by all of the claimants with proper address given, must be submitted with this waiver.
7. This form must be filed no later than September 1st for the upcoming assessment year in the BLM State Office where the mining claims or sites are recorded, or the waiver cannot be granted by the BLM. (Example: To obtain a waiver for the assessment year 2012, which begins on September 1, 2011, you must qualify for and file for a waiver no later than September 1, 2011, in the proper BLM State Office.)
8. For all mining claims which require assessment work, you must record an affidavit of labor on or before the December 30th immediately following the filing of this waiver. For all other mining claims or sites waived, you must record a notice of intent to hold on or before the December 30th immediately following the filing of this waiver.
9. Mill and tunnel sites may also be listed on this waiver and be waived from payment of the maintenance fee. A notice of intent to hold for these sites is required to be filed by the December 30th following the filing of this waiver.

FOR OFFICIAL USE ONLY

RECEIVED
BLM AZ STATE OFFICE

2018 SEP -4 P 12:16

PHOENIX, ARIZONA

PHOENIX AZ 852

30 AUG 2018 PM 9 L



US DEPT OF Interior
Blm- AZ STATE OFFICE
One North Central Ave, Suite 800
Phoenix AZ 85004-4427

85004\$4427 C041



RECEIVED
BLM AZ STATE OFFICE

2018 SEP -4 P 12:16

PHOENIX, ARIZONA

PHOENIX AZ 852

30 AUG 2018 PM 9 1



US DEPT OF Interior
BLM - AZ STATE OFFICE
ONE NORTH CENTRAL AVE, Suite 800
Phoenix AZ 85004-4427

8500434427 C041

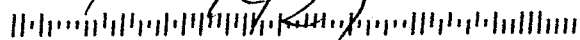

UNITED STATES
DEPARTMENT OF THE INTERIOR
BUREAU OF LAND MANAGEMENT
MAINTENANCE FEE WAIVER CERTIFICATION

SEE INSTRUCTIONS ON PAGE 2

449125
449281
FORM APPROVED
OMB NO. 1004-0114
Expires: January 31, 2020

1. This small miner waiver is filed for the assessment year beginning on September 1, 2018 and ending on September 1, 2019
2. The undersigned and all related parties owned ten or fewer mining claims, mill, or tunnel sites located and maintained on Federal lands in the United States of America on September 1, 2018
3. The undersigned have performed the assessment work required by law for each mining claim listed prior to filing this waiver and understand that by filing this form, the undersigned must file an affidavit of assessment work with the Bureau of Land Management (BLM) by the December 30th following the filing of this waiver.
4. The undersigned understand that if the assessment work obligation has not yet come due under 30 U.S.C. 28 (for those claims in their first assessment year only), a notice of intent to hold reciting this condition must be recorded by the December 30th following the filing of this waiver.
5. The undersigned understand that mill and tunnel sites may also be listed on this waiver and be waived from payment of the maintenance fee, and that a notice of intent to hold for these sites is required to be filed with the BLM by the December 30th following the filing of this waiver.
6. The undersigned understand and acknowledge that pursuant to 43 U.S.C. 1212 and 18 U.S.C. 1001, the filing or recording of a false, fictitious, or fraudulent document with the BLM may result in a fine of up to \$250,000, a prison term not to exceed five years, or both.
7. The mining claims, mill or tunnel sites for which this waiver from payment of the maintenance fees is requested are:

CLAIM OR SITE NAME	BLM RECORDATION SERIAL NUMBER
1. Fortitude # 1	Amc 449125
2. Fortitude # 3	Amc 449126
3. Fortitude # 4	Amc 449127
4. Fortitude # 5	Amc 449128
5. Fortitude # 6	Amc 449281
6. Fortitude # 7	Amc 449282
7.	
8.	
9.	
10.	

The owner(s) (claimants) of the above mining claims and sites are:

Kelley Smelter
(Owner's Name - Please Print)
3922 MARK TWAIN DR
(Owner's Mailing Address)

[Signature]
(Owner's Signature)
PineTOP
(City)
AZ 85935
(State) (Zip Code)

(Owner's Name - Please Print)

(Owner's Mailing Address)

(Owner's Name - Please Print)

(Owner's Mailing Address)

(Owner's Name - Please Print)

(Owner's Mailing Address)

(Continued on page 2)

(Owner's Signature)

(City) (State) (Zip Code)

(Owner's Signature)

(City) (State) (Zip Code)

(Owner's Signature)

(City) (State) (Zip Code)

RECEIVED
BLM AZ STATE OFFICE
2018 SEP - 4 P 12:16
PHOENIX, ARIZONA

(Owner's Name - Please Print)

(Owner's Signature)

(Owner's Mailing Address)

(City)

(State)

(Zip Code)

(Owner's Name - Please Print)

(Owner's Signature)

(Owner's Mailing Address)

(City)

(State)

(Zip Code)

(Owner's Name - Please Print)

(Owner's Signature)

(Owner's Mailing Address)

(City)

(State)

(Zip Code)

(Owner's Name - Please Print)

(Owner's Signature)

(Owner's Mailing Address)

(City)

(State)

(Zip Code)

18 U.S.C. 1001 and 43 U.S.C. 1212 make it a crime for any person knowingly and willfully to make to any department or agency of the United States any false, fictitious or fraudulent statements or representations as to any matter within its jurisdiction.

INSTRUCTIONS

1. This certification is made under the provisions of 43 U.S.C. § 1744 and 30 U.S.C. § 28-28k and the regulations thereunder (43 CFR Part 3830).
2. The claimant(s) must fill in the dates in paragraph 1 for the beginning and ending of the assessment year for which this waiver is sought.
3. The claimant(s) must fill in the date in paragraph 2 for the beginning of the assessment year for which this waiver is sought.
4. All claim and site names and BLM serial numbers must be listed for the mining claims, mill sites, and tunnel sites for which the waiver is sought.
5. All owners of the mining claims, mill sites, and tunnel sites and their addresses must be given.
6. This waiver form must be signed by all the claimants or their designated agent, in original form. If an agent is designated, a notarized designation of agent, signed by all of the claimants with proper address given, must be submitted with this waiver.
7. This form must be filed no later than September 1st for the upcoming assessment year in the BLM State Office where the mining claims or sites are recorded, or the waiver cannot be granted by the BLM. (Example: To obtain a waiver for the assessment year 2012, which begins on September 1, 2011, you must qualify for and file for a waiver no later than September 1, 2011, in the proper BLM State Office.)
8. For all mining claims which require assessment work, you must record an affidavit of labor on or before the December 30th immediately following the filing of this waiver. For all other mining claims or sites waived, you must record a notice of intent to hold on or before the December 30th immediately following the filing of this waiver.
9. Mill and tunnel sites may also be listed on this waiver and be waived from payment of the maintenance fee. A notice of intent to hold for these sites is required to be filed by the December 30th following the filing of this waiver.

FOR OFFICIAL USE ONLY

449125

449281

NOTICE OF INTENTION TO HOLD MINING CLAIMS/SITES

When Recorded Return Document to:

Kelley Smelser
3922 Mark Twain Dr
Pineopol AZ 85935

BLM
 Date
 Stamp

RECEIVED
 M AZ STATE OFFICE
 2018 AUG 23 A 9:32
 PHOENIX, ARIZONA

☐ Check here if this is a change of address.

Telephone: _____

E-mail Address: thesmels1@gmail.com

I (We) intend to hold the claim(s) and/or site(s) listed below for the calendar year 20____, and I (We) have filed or will file a Notice of Intent to Hold in the county where the claim (s) is located.

Reason for filing a Notice of Intent to Hold instead of an assessment work filing (check one):

- ☐ Maintenance fee was paid to maintain claim(s) during this assessment year.
☐ Mill or tunnel sites.
☐ Claim(s) was located during the current assessment year.
☐ BLM has deferred assessment work (attach copy of decision granting deferment, or pending petition for deferment including date petition was filed.)

Line No.	AMC NUMBER	CLAIM/SITE NAME	COUNTY RECORDER DATA (If available)	TWP	RNG	SEC
1	449125	fortitude #1				
2	449126	fortitude #3				
3	449127	fortitude #4				
4	449128	fortitude #5				
5	449281	fortitude #6				
6	449282	fortitude #7				
7						
8						
9						
10						

NO. OF CLAIMS 6AMOUNT 6000RECEIPT NO. 4242417INIT: DER

** BLM-ASQ**

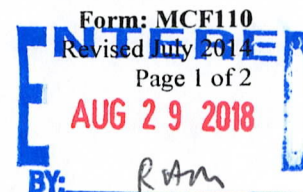

NOTICE OF INTENTION TO HOLD MINING CLAIMS/SITES
page 2

RECEIVED BLM AZ STATE OFFICE 2010 AUG 23 A 9:39 PHOENIX, ARIZONA	BLM Date Stamp
---------------------------------------------------------------------------	----------------------

1. State of Arizona, County of _____

2. I (Name) _____

3. Reside at (Address) _____

City _____ County _____ State _____ Zip _____ being duly sworn, depose and say that I am a citizen of the United States, more than eighteen years of age, that all of the facts set forth in this notice, subject to the provisions and penalties of 18 U.S.C. 1001 pertaining to the filing of false, fictitious, or fraudulent statements with the United States, are true and correct according to the best of my knowledge, information and belief.

4. Owner's name and address (If not shown in Items 1-3 above). _____

5. Dated: _____ Signature: _____

Bureau of Land Management
Arizona State Office
www.blm.gov/az

No. of Claims: _____ x \$10 = _____
Check No: _____ Init. _____
Receipt No.: _____
For BLM Use Only

Form: MCF110
Revised July 2014
Page 2 of 2

United States Department of the Interior
Bureau of Land Management
 DIV OF LANDS, MINRLS & ENERGY
 ONE N CENTRAL AVE
 PHOENIX, AZ 85004 -4427
 Phone: 602-417-9200

Receipt

No:

4242417

Transaction #: 4357845**Date of Transaction:** 08/23/2018**CUSTOMER:**

KELLEY SMELSER
 3922 MARK TWAIN DR
 PINETOP, AZ 85935-8631 US

LINE #	QTY	DESCRIPTION	REMARKS	UNIT PRICE	TOTAL
1	1.00	LOCATABLE MINERALS / MINING CLAIMS-NOT NEW-UNADJUD, ONE AUTH NO. ONLY / MINING CLAIM MONEY RECEIVED CASES: AMC449125/\$60.00	2018 NOI/6	- n/a -	60.00
TOTAL:					\$60.00

PAYMENT INFORMATION

NOTE: Items will appear on credit card statement as "Bureau of Land Mgmt CO".

1	AMOUNT:	60.00	POSTMARKED:	N/A
	TYPE:	CREDIT CARD	RECEIVED:	08/23/2018
	NAME:	SMELSER, KELLEY 3922 MARK TWAIN DR PINETOP AZ 85935-8631 US		
	CARD NO:	XXXXXXXXXXXX3005	AUTH CODE:	166594
	NAME ON CARD:	KELLEY SMELSER		
	SIGNATURE:			

REMARKS

This receipt was generated by the automated BLM Collections and Billing System and is a paper representation of a portion of the official electronic record contained therein.

NOTICE!!

These documents have been scanned!

Do not place un-scanned documents beneath this notice!

Do not remove this notice from this file!

GPO Jacket No. 560-102
Print Order 61540
Rise Business Services, LLC
Job=AZ15 4/26/2019



Box Number= AZ15003



Claim Begin-End: AMC449125-AMC449128

5 Miscellaneous



AZ15003-43

AMC450400-AMC453366

United States Department of the Interior
Bureau of Land Management
 DIV OF LANDS, MINRLS & ENERGY
 ONE N CENTRAL AVE
 PHOENIX, AZ 85004 -4427
 Phone: 602-417-9200

Receipt

No: 4104165

Transaction #: 4216885	
Date of Transaction: 03/05/2018	
CUSTOMER:	
	KELLEY SMELSER 3922 MARK TWAIN DR PINETOP, AZ 85935-8631 US

LINE #	QTY	DESCRIPTION	REMARKS	UNIT PRICE	TOTAL
1	1.00	LOCATABLE MINERALS / MINING CLAIMS- NOT NEW-UNADJUD, ONE AUTH NO. ONLY / MINING CLAIM MONEY RECEIVED CASES: AMC449125 /\$40.00	AMEND (4)	- n/a -	40.00
TOTAL:					\$40.00

PAYMENT INFORMATION			
NOTE: Items will appear on credit card statement as "Bureau of Land Mgmt CO".			
1	AMOUNT:	40.00	POSTMARKED: N/A
	TYPE:	CREDIT CARD	RECEIVED: 03/05/2018
	NAME:	SMELSER, KELLEY 3922 MARK TWAIN DR PINETOP AZ 85935-8631 US	
	CARD NO:	XXXXXXXXXXXX7880	AUTH CODE: 063312
	NAME ON CARD:	KELLEY R SMELSER	
	EXPIRES:	11/2020	
	SIGNATURE:		

REMARKS

This receipt was generated by the automated BLM Collections and Billing System and is a paper representation of a portion of the official electronic record contained therein.

*CORRECT LLD & MAP
ON AMC449125-449128.*





United States Department of the Interior

BUREAU OF LAND MANAGEMENT

Arizona State Office
One North Central Avenue, Suite 800
Phoenix, Arizona 85004-4427

MAR 20 2018



PHOENIX, ARIZONA

2018 APR -9 P 3:13

RECEIVED
BLM ARIZONA STATE OFFICE

In Reply Refer To:
3800 (9200) RM
AMC449125

CERTIFIED MAIL - RETURN RECEIPT REQUESTED No. 9214 8901 9403 8304 9686 88

NOTICE

KELLEY SMELSER
3922 MARK TWAIN DR
PINETOP, AZ 85935-8631

:
:
:

This Notice Affects the Claims
Shown in the Block Below.

AMC449128
FORTITUDE #5

Mining Claim Location Notices – Corrections Required

Pursuant to Title 43 Code of Federal Regulations (CFR) 3832.1, this office received your notice(s) of location for recordation of mining claims. In accordance with 43 CFR 3832.11 and 3832.12, the claim(s) listed above are not properly located. Because they are not properly located we cannot record them as filed. They must be corrected as noted below or they will be declared null and void.

No location date was provided.

You must provide the requested information for each claim listed above to correct the defects. Please do this by providing a copy of your location notice with the appropriate corrections, and note at the top of the form that it is a "Corrected Copy of Location Notice". If it is only the map that is missing or needs to be corrected, please provide the map. If the information is not received within the 30-day timeframe, the mining claims will be declared null and void ab initio.

Amendments Already Filed because the
Areas marked on map were too big-

Kelley Smelser

If additional information is required, please contact RéAnn Myers at 602-417-9413. Please include your AMC serial number(s) on all correspondence.

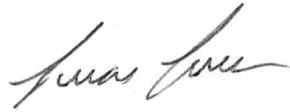

Lucas Lucero
Deputy State Director
Lands, Minerals and Energy Division

RECEIVED
DLN AND STATE OFFICE
2018 APR -9 P 3:13
PHOENIX, ARIZONA

Kelley Smelser
85935

PHOENIX AZ 852

07 APR 2018 PM 5 L



RECEIVED
BLM ARIZONA STATE OFFICE

2018 APR -9 P 3:13

PHOENIX, ARIZONA

US Dept of The Interior

Blm ARIZONA STATE OFFICE

One North Central Ave Suite 800

Phoenix AZ 85004-4927

85004-238142



NOTICE!!

These documents have been scanned!

Do not place un-scanned documents beneath this notice!

Do not remove this notice from this file!

GPO Jacket No. 560-102
Print Order 61540
Rise Business Services, LLC
Job=AZ15 4/26/2019



Box Number= AZ15003



Claim Begin-End: AMC449125-AMC449128

6 Location Notices-Amendments and Supporting Documents



AZ15003-43

AMC450400-AMC453366

MINING CLAIM STATUS REPORT

Data Entered: 2/26/18 RAM

MTP Checked By: PER
GEO Checked By: _____

LEAD SERIAL NUMBER: AMC 449125 thru AMC 449128

NUMBER OF CLAIMS & TYPE:

CHARGES:

LODE
4
PLACER

ASSOCIATION PLACER

MILL SITE

TUNNEL SITE

Processing Fee @ \$20 = \$ 80-
Location Fee @ \$37 = \$ 148-
Maintenance Fee @ \$155 = \$ 620-
Add'l Maint Fee for Assoc Placer = \$.
SUBTOTAL \$ 848-

Other Fees \$ _____

Other Fees \$ _____
TOTAL \$ _____

TOTAL ACREAGE: 20 Per Claim
(Placer Only)

NUMBER OF LOCATORS: 1

DOCUMENTS RECEIVED VIA: Over-the-Counter ☒ Mail ☐ TIMELY FILED: Yes ☒ No ☐

LEGAL DESCRIPTION: T 8N R 2E SEC 29
T _____ R _____ SEC _____
T _____ R _____ SEC _____
T _____ R _____ SEC _____
T _____ R _____ SEC _____

BLM ☒ FOREST SERVICE ☐ SUBJ TO PL 359: Yes ☐ No ☐
WILDERNESS AREA ☐

SPLIT ESTATE: N/A ☐ SX ☐ PX ☐ OTHER ☐
SRHA ☐ Was proper Notice filed if located on SHRA Land? Yes ☐ No ☐

RECONVEYED MINERALS ON BLM LAND REQUIRE OPENING ORDER FROM 1944 TO 1993:

Open to Entry On _____ N/A ☐

COMMENTS/STATUS: VOID ☐ PARTIALLY VOID ☐ PVT MINERALS ☐ WITHDRAWN LANDS ☐
OTHER ☐

☐ Claimant acknowledges that portions of the following claim(s) site(s) may be void or voidable.

Printed Name of Claimant _____ Signature of Claimant _____

*****FINAL ADJUDICATION*****

DATE 3/6/2018 INITIALS RAM

LOCATION NOTICE FOR PLACER MINING CLAIM

☒ Amendment BLM Serial # AMC449125

NOTICE IS HEREBY GIVEN that the fortitude
#1 placer mining claim has been located by

Kelley Smeiser whose current mailing
address is 3922 MARK TWAIN DR
PINETOP AZ 85935

BLM
Date
Stamp

RECEIVED
BLM AZ STATE OFFICE
2018 MAR -5 A 10:24
PHOENIX, ARIZONA

The general course of this claim is Placer and it is situated in YAVAPAI
County, Arizona. This claim is 1320 feet in length and 660 feet in width.

20 Total Claim Acreage. This claim runs from the location monument on which this location notice is
posted at the SE corner of the claim approximately 1320 feet in a N direction to the
NE end line and 660 feet in a W direction to the SW end line. This claim is
marked by four monuments, one at each corner of the claim.

The location monument on which this notice is posted is situated within Section 29, Township
8 N, Range 2 E, Gila Salt River Base and Meridian, Arizona. This claim encompasses
portions of the following legal subdivision(s) if located by legal subdivision or the following quarter section(s),
section(s), Township(s) and Range(s) E 1/2 NW 1/4 NW 1/4
S29 T8N R2E, Gila Salt River Base and Meridian, Arizona.

The locality of this claim with reference to some natural object or permanent monument and additional information
(if any) concerning its locality are as follows: Sign on Gate OUT OF floodway
Area

The above information is shown on the attached map.

DATED AND POSTED on the ground this 3 day of MARCH, 20 18.

☒ LOCATOR(s) ☐ AGENT

Print Name(s) Kelley Smeiser

Signature(s) Kelley Smeiser

Form MCF102
Revised July 2014

This form is available from the Arizona Geological Survey and may be reproduced.

AMC 449125

MINING CLAIM MAP

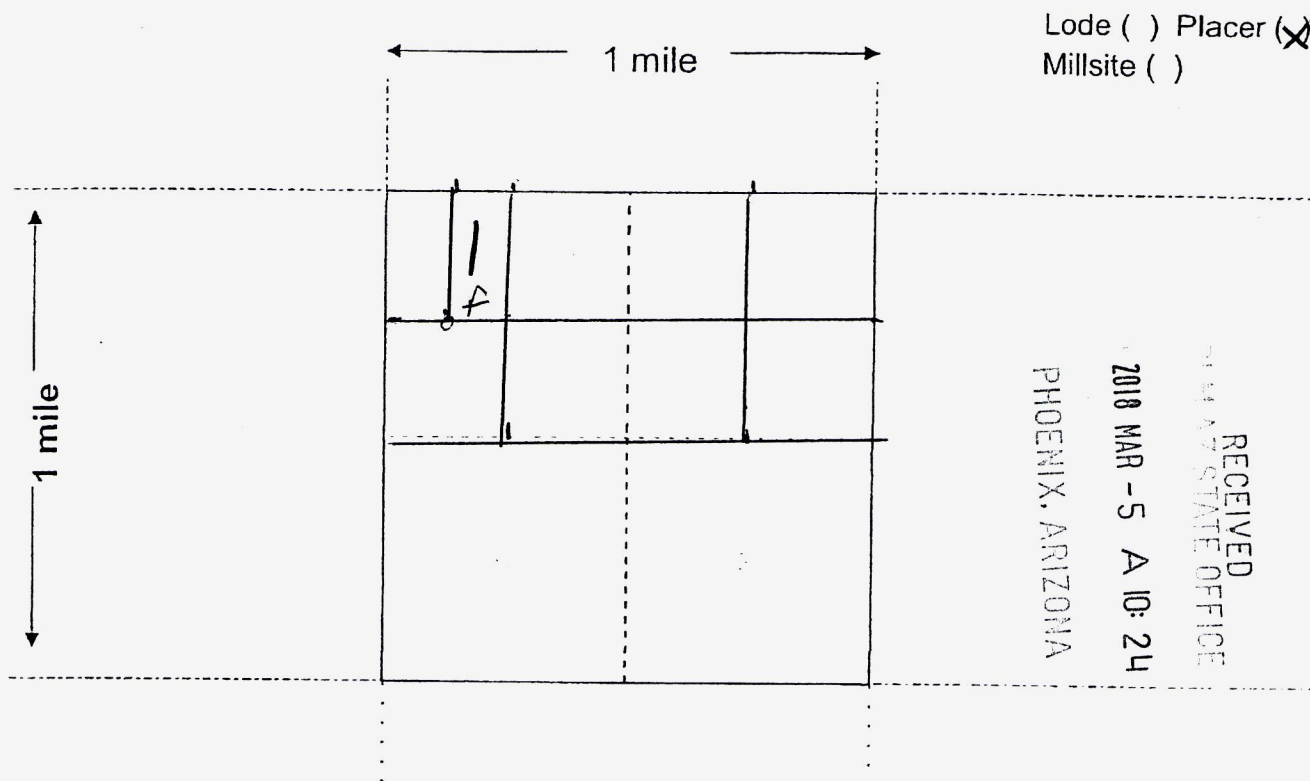

Scale: 1" = 2000 feet



- The above map depicts the FORTITUDE # 1 mining claim, which is located in Section (s) 29, Township 8 N, Range 2 E, Gila and Salt River Base and Meridian, YAVAPAI County, Arizona. Total claim acreage is 20
- The type of corner and location monuments used are as follows: ROCK monument
IS RIVER PLACE SIGN + LOCATION NEARBY GATE
- The bearings and distances in degrees and feet between claim corners and to a public land survey monument are as depicted on the map.
- If the claim is a placer or millsite claim with exterior limits conforming to legal subdivisions of the public survey, provide a legal description of the claim E 1/2 NW 1/4 NW 1/4
S 29 T 8 N R 2 E

Form MCF100a
Revised July 2014

This form is available from the Arizona Geology Survey and may be reproduced.

LOCATION NOTICE FOR PLACER MINING CLAIM

☐ Amendment BLM Serial # 449125

NOTICE IS HEREBY GIVEN that the Fortitude#1

_____ placer mining claim has been located by

Kelley Smelser whose current mailing
address is 3922 MARKTWAIN DR

PineTOP AZ 85935

The general course of this claim is Placer and it is situated in YAVAPAI

County, Arizona. This claim is 1320 feet in length and 660 feet in width.

20 Total Claim Acreage. This claim runs from the location monument on which this location notice is posted at the SE corner of the claim approximately 660 feet in a W direction to the SW end line and 1320 feet in a N direction to the NE end line. This claim is marked by four monuments, one at each corner of the claim.

The location monument on which this notice is posted is situated within Section 29, Township 8 N, Range 2 E, Gila Salt River Base and Meridian, Arizona. This claim encompasses portions of the following legal subdivision(s) if located by legal subdivision or the following quarter section(s), section(s), Township(s) and Range(s) EW NW 1/4 SE 1/4 R 29
T 8 N R 2 E, Gila Salt River Base and Meridian, Arizona.

The locality of this claim with reference to some natural object or permanent monument and additional information (if any) concerning its locality are as follows: Center of River Bed monument
Placed - Sign And location Noticed Placed at Gate
1en

The above information is shown on the attached map.

DATED AND POSTED on the ground this 22 day of February, 20 18.

☒ LOCATOR(s) ☐ AGENT

Print Name(s) Kelley Smelser

Signature(s) Kelley Smelser

2018 FEB 22 A 9:16

PHOENIX, ARIZONA

RECEIVED
BLM STATE OFFICE

BLM
Date
Stamp

AMC449125

Form MCF102
Revised July 2014

MINING CLAIM MAP

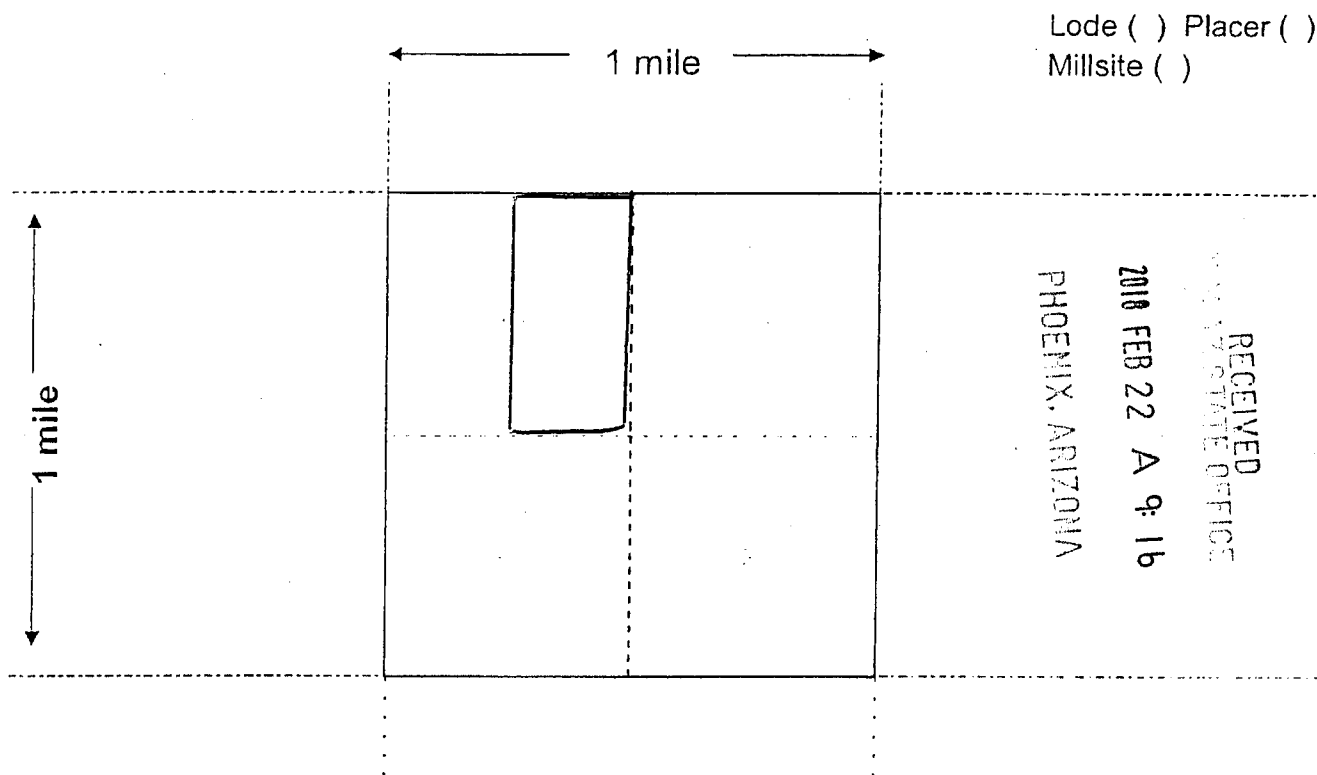

Scale: 1" = 2000 feet



1. The above map depicts the Fortitude #1 mining claim, which is located in Section (s) 29, Township 8N N, Range 2 E, Gila and Salt River Base and Meridian, YAVAPAI County, Arizona. Total claim acreage is 20 Acres
2. The type of corner and location monuments used are as follows: monument in center of River - Sign + Locator Papers AT Nearby Gate
3. The bearings and distances in degrees and feet between claim corners and to a public land survey monument are as depicted on the map.
4. If the claim is a placer or millsite claim with exterior limits conforming to legal subdivisions of the public survey, provide a legal description of the claim _____

AMC 49125

Form MCF100a
Revised July 2014

This form is available from the Arizona Geology Survey and may be reproduced.

LOCATION NOTICE FOR PLACER MINING CLAIM

☒ Amendment BLM Serial # AMC 449126

NOTICE IS HEREBY GIVEN that the fortitude
3 placer mining claim has been located by

Kelley Smelser whose current mailing
address is 3922 MARK TWAIN DR
PINETOP AZ 85935

BLM
Date
Stamp

RECEIVED
BLM ARIZONA STATE OFFICE
2018 MAR -5 A 10:24
PHOENIX, ARIZONA

The general course of this claim is PLACER and it is situated in YAVAPAI
County, Arizona. This claim is 1320 feet in length and 660 feet in width.

20 Total Claim Acreage. This claim runs from the location monument on which this location notice is
posted at the SW corner of the claim approximately 1320 feet in a N direction to the
NW end line and 660 feet in a E direction to the SE end line. This claim is
marked by four monuments, one at each corner of the claim.

The location monument on which this notice is posted is situated within Section 29, Township
8 N, Range 2 E, Gila Salt River Base and Meridian, Arizona. This claim encompasses
portions of the following legal subdivision(s) if located by legal subdivision or the following quarter section(s),
section(s), Township(s) and Range(s) W4 NE4 NW4
S29 T8N R2E, Gila Salt River Base and Meridian, Arizona.

The locality of this claim with reference to some natural object or permanent monument and additional information
(if any) concerning its locality are as follows: Sign AM GATE OUT OF floodway
AREA

_____ The above information is shown on the attached map.

DATED AND POSTED on the ground this 3 day of march, 20 18.

☒ LOCATOR(s) ☐ AGENT

Print Name(s) Kelley Smelser
Signature(s) Kelley Smelser

Form MCF102
Revised July 2014

This form is available from the Arizona Geological Survey and may be reproduced.

AMC 449126

MINING CLAIM MAP

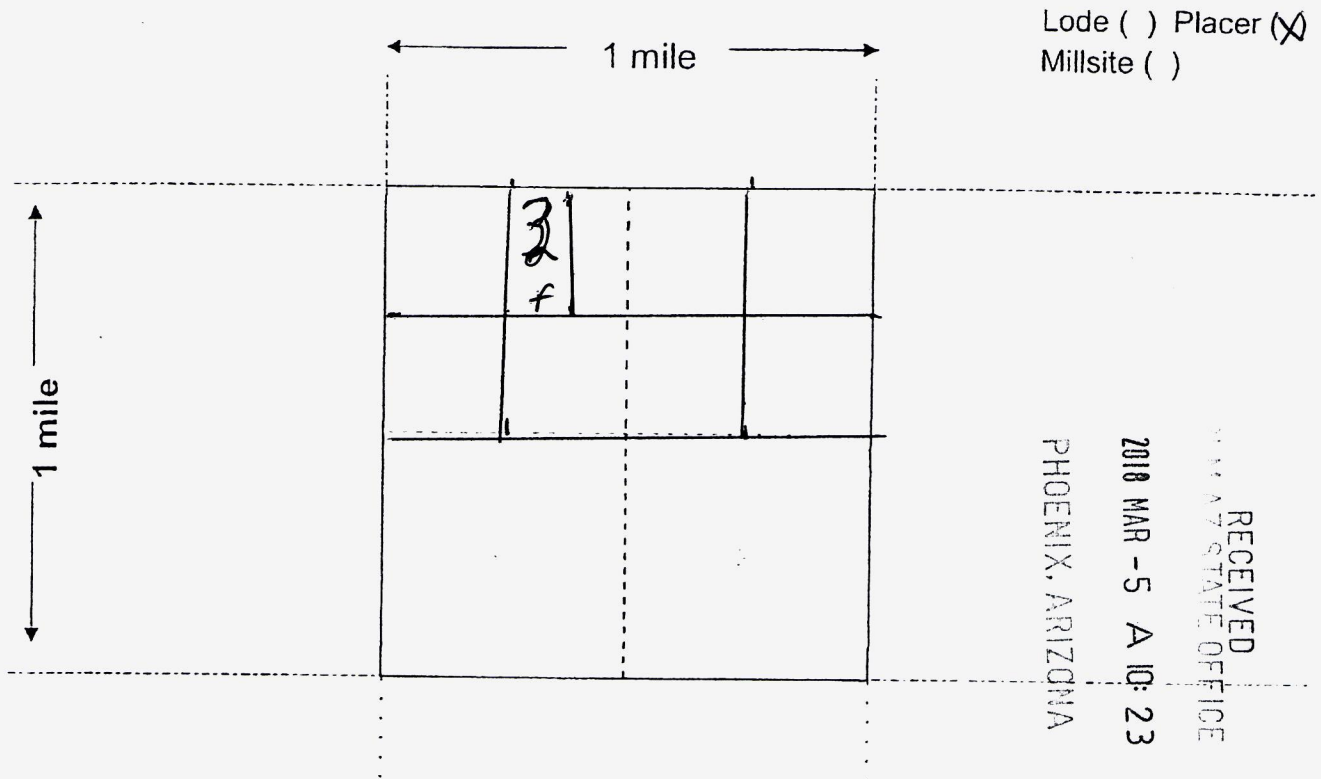

Scale: 1" = 2000 feet



- The above map depicts the FORTITUDE #2 mining claim, which is located in Section (s) 29, Township 8 N, Range 2 E, Gila and Salt River Base and Meridian, YAVAPAI County, Arizona. Total claim acreage is 20
- The type of corner and location monuments used are as follows: ROCK monument
- The bearings and distances in degrees and feet between claim corners and to a public land survey monument are as depicted on the map.
- If the claim is a placer or millsite claim with exterior limits conforming to legal subdivisions of the public survey, provide a legal description of the claim W 1/4 NE 1/4 NW 1/4
S 29 T 8 N R 2 E

Form MCF100a
Revised July 2014

This form is available from the Arizona Geology Survey and may be reproduced.

LOCATION NOTICE FOR PLACER MINING CLAIM

☐ Amendment BLM Serial # 449126

NOTICE IS HEREBY GIVEN that the Fortitude #3

_____ placer mining claim has been located by

Kelley Smelser whose current mailing

address is 3922 Mark Twain Dr

Pinecroft AZ 85935

BLM
Date
Stamp

RECEIVED
BLM STATE OFFICE
2010 FEB 22 A 9:16
PHOENIX, ARIZONA

The general course of this claim is Placer and it is situated in YAVAPAI

County, Arizona. This claim is 1320 feet in length and 660 feet in width.

20 Total Claim Acreage. This claim runs from the location monument on which this location notice is posted at the SW corner of the claim approximately 660 feet in a E direction to the SE end line and 1320 feet in a N direction to the NW end line. This claim is marked by four monuments, one at each corner of the claim.

The location monument on which this notice is posted is situated within Section 29, Township 8 N, Range 2 E, Gila Salt River Base and Meridian, Arizona. This claim encompasses portions of the following legal subdivision(s) if located by legal subdivision or the following quarter section(s), section(s), Township(s) and Range(s) W1/4 NE1/4 SE1/4 R29 T8N R2E, Gila Salt River Base and Meridian, Arizona.

The locality of this claim with reference to some natural object or permanent monument and additional information (if any) concerning its locality are as follows: Rock in center of River bed
Sign and location papers on nearby gate

_____ The above information is shown on the attached map.

DATED AND POSTED on the ground this 22 day of February, 2018.

☒ LOCATOR(s) ☐ AGENT

Print Name(s) Kelley Smelser

Signature(s) Kelley Smelser

Form MCF102
Revised July 2014

This form is available from the Arizona Geological Survey and may be reproduced.

AMC0009126

MINING CLAIM MAP

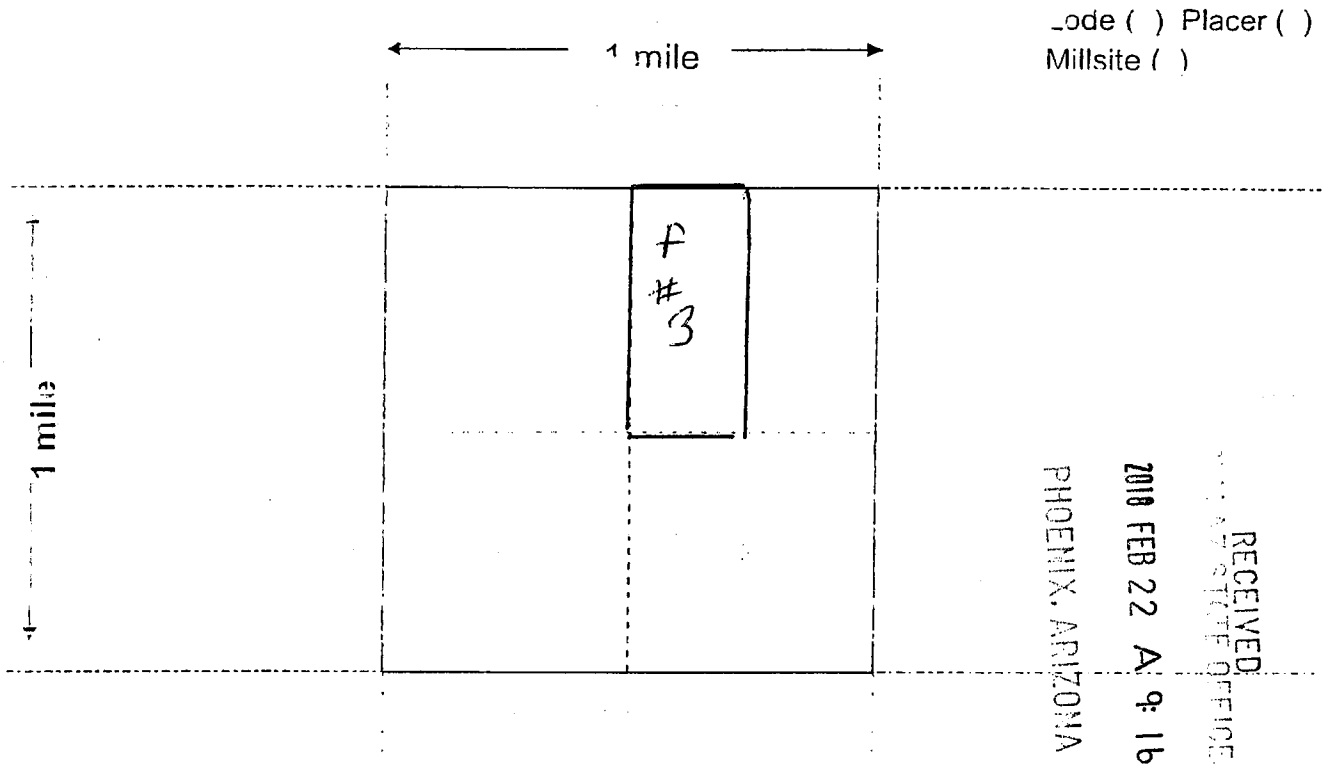

Scale: 1" = 2000 feet

1. The above map depicts the FORTITUDE #3 mining claim, which is located in Section (s) 29, Township 8 N, Range 2 E, Gila and Salt River Base and Meridian, YAVAPAI County, Arizona. Total claim acreage is 20

2. The type of corner and location monuments used are as follows: ROCK in center OF River BOTTOM - SIGN + LOCATION PAPERS ON NEARBY GATE

3. The bearings and distances in degrees and feet between claim corners and to a public land survey monument are as depicted on the map

4. Is the claim a placer or millsite claim with exterior limits conforming to legal subdivisions of the public survey, provide a legal description of the claim W 1/4 NE 1/4 SE 1/4 R 29
TWN 8N R 2E

Form MCF100a
Revised July 2014

This form is available from the Arizona Geology Survey and may be reproduced.

LOCATION NOTICE FOR PLACER MINING CLAIM

☒ Amendment BLM Serial # Amc 449127

NOTICE IS HEREBY GIVEN that the fortitude
4 placer mining claim has been located by
Kelley Smelser whose current mailing
address is 3922 Mark Twain Dr
Pine Top AZ 85935

BLM
Date
Stamp

RECEIVED
MINERAL STATE OFFICE
2018 MAR -5 A 10:23
PHOENIX, ARIZONA

The general course of this claim is Placer and it is situated in YAVAPAI
County, Arizona. This claim is 1320 feet in length and 660 feet in width.

20 Total Claim Acreage. This claim runs from the location monument on which this location notice is
posted at the NW corner of the claim approximately 1320 feet in a S direction to the
SW end line and 660 feet in a E direction to the NE end line. This claim is
marked by four monuments, one at each corner of the claim.

The location monument on which this notice is posted is situated within Section 29, Township
8 N, Range 2 E, Gila Salt River Base and Meridian, Arizona. This claim encompasses
portions of the following legal subdivision(s) if located by legal subdivision or the following quarter section(s),
section(s), Township(s) and Range(s) E 1/2 NE 1/4 NW 1/4
S29 T8N R2E, Gila Salt River Base and Meridian, Arizona.

The locality of this claim with reference to some natural object or permanent monument and additional information
(if any) concerning its locality are as follows: Sign AM GATE OUT OF floodway
Area

The above information is shown on the attached map.

DATED AND POSTED on the ground this 3 day of march 2018.

☒ LOCATOR(s) ☐ AGENT

Print Name(s) Kelley Smelser

Signature(s) Kelley Smelser

Form MCF102
Revised July 2014

This form is available from the Arizona Geological Survey and may be reproduced.

Amc 449127

MINING CLAIM MAP

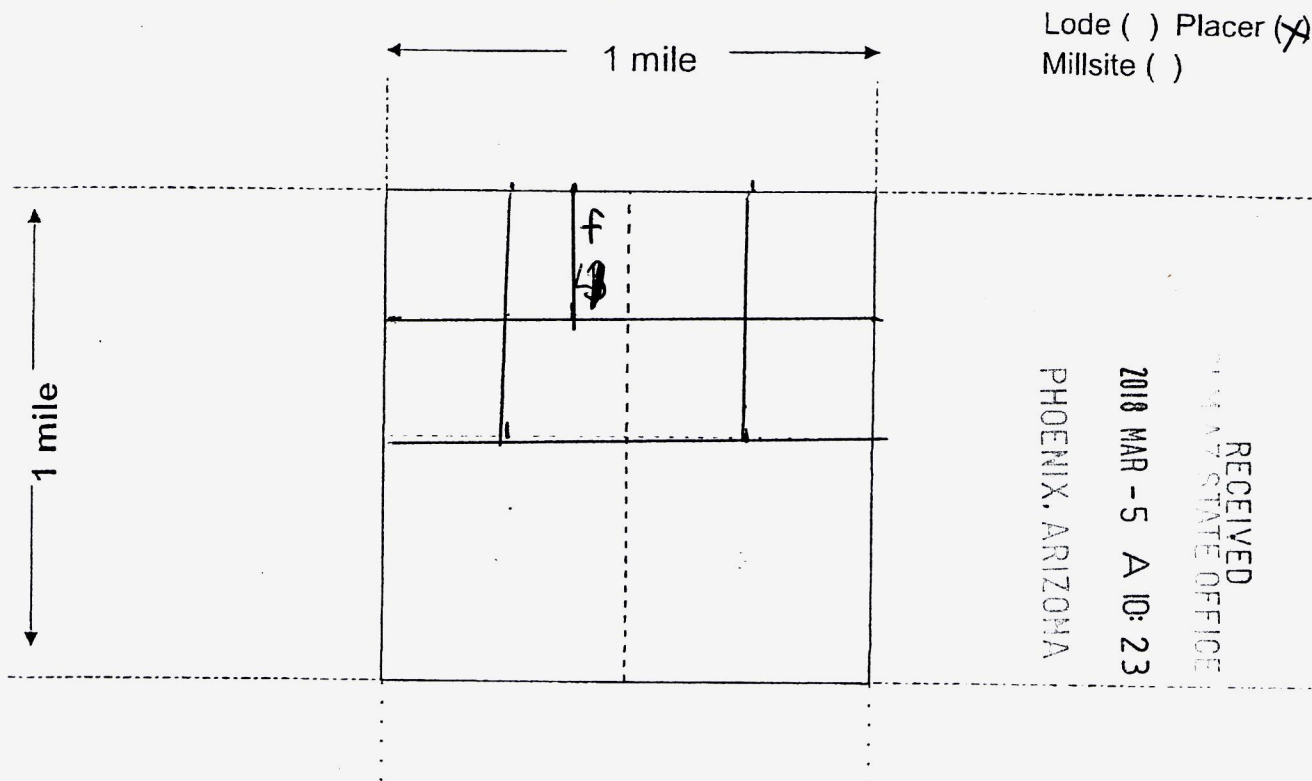

Scale: 1" = 2000 feet



- The above map depicts the FORTITUDE #104 mining claim, which is located in Section (s) 29, Township 8 N, Range 2 E, Gila and Salt River Base and Meridian, YAVAPAI County, Arizona. Total claim acreage is 20
- The type of corner and location monuments used are as follows: ROCK monument
- The bearings and distances in degrees and feet between claim corners and to a public land survey monument are as depicted on the map.
- If the claim is a placer or millsite claim with exterior limits conforming to legal subdivisions of the public survey, provide a legal description of the claim E 1/2 NE 1/4 NW 1/4
S 29 T 8 N R 2 E

Form MCF100a
Revised July 2014

This form is available from the Arizona Geology Survey and may be reproduced.

LOCATION NOTICE FOR PLACER MINING CLAIM

☐ Amendment BLM Serial # 449127

NOTICE IS HEREBY GIVEN that the Fortitude #9

_____ placer mining claim has been located by

Kellay Smelser whose current mailing
address is 3922 MARK TWAIN DR
PINE TOP AZ 85935

BLM
Date
Stamp

RECEIVED
U.S. STATE OFFICE
2018 FEB 22 A 9:16
PHOENIX, ARIZONA

The general course of this claim is PIACER and it is situated in YAVAPAI County, Arizona. This claim is 1320 feet in length and 660 feet in width.

20 Total Claim Acreage. This claim runs from the location monument on which this location notice is posted at the NW corner of the claim approximately 660 feet in a E direction to the NE end line and 1320 feet in a S direction to the SW end line. This claim is marked by four monuments, one at each corner of the claim.

The location monument on which this notice is posted is situated within Section 29, Township 8 N, Range 2 E, Gila Salt River Base and Meridian, Arizona. This claim encompasses portions of the following legal subdivision(s) if located by legal subdivision or the following quarter section(s), section(s), Township(s) and Range(s) W 1/4 SE 1/4 SE 1/4 R 29
T 8 N R 2 E, Gila Salt River Base and Meridian, Arizona.

The locality of this claim with reference to some natural object or permanent monument and additional information (if any) concerning its locality are as follows: Monument in center of River
Bottom - Sign and Location Pithers AT NEARBY GATE

The above information is shown on the attached map.

DATED AND POSTED on the ground this 22 day of February 2018.

☒ LOCATOR(s) ☐ AGENT

Print Name(s)

Signature(s)

Form MCF102
Revised July 2014

MINING CLAIM MAP

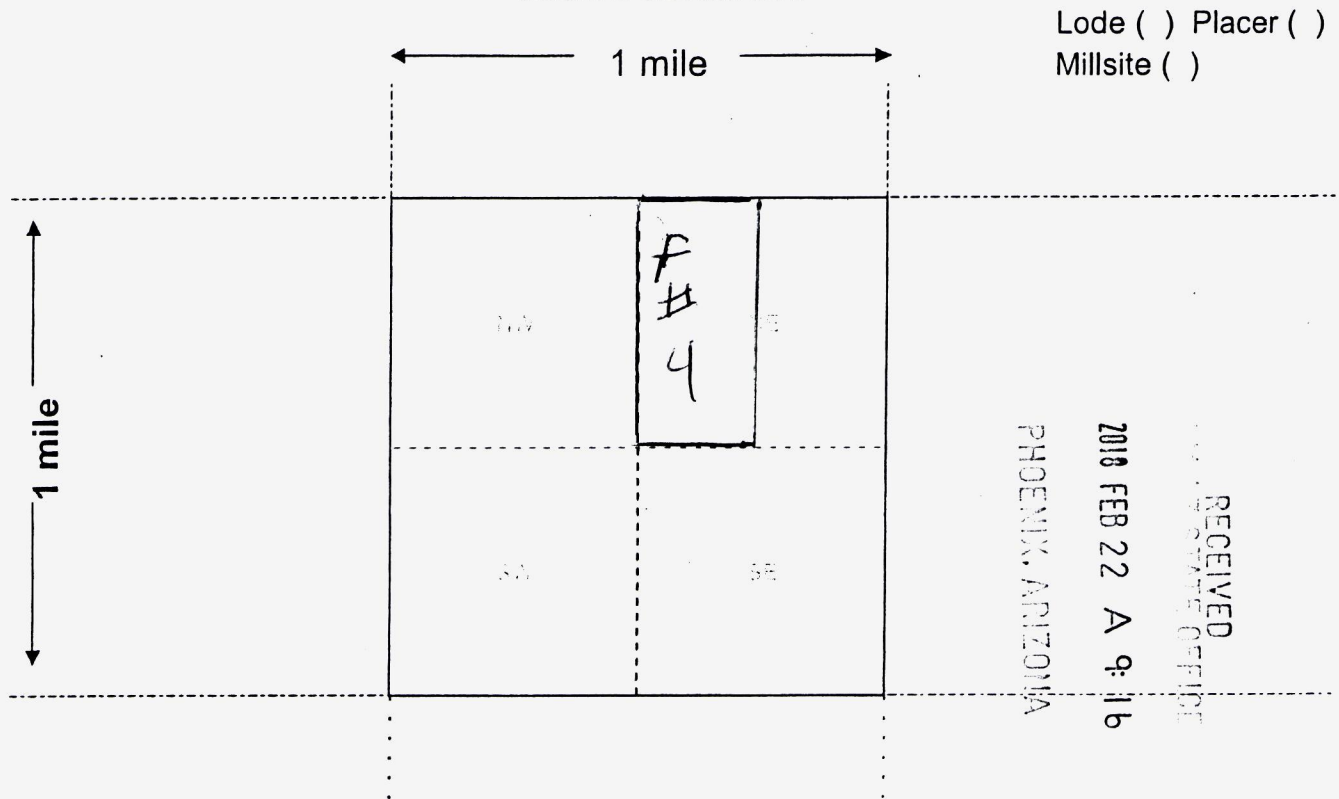

Scale: 1" = 2000 feet



1. The above map depicts the Fortitude # 4 mining claim, which is located in Section (s) 29, Township 8 N, Range 2 E, Gila and Salt River Base and Meridian, Yavapai County, Arizona. Total claim acreage is 20
2. The type of corner and location monuments used are as follows: Rock Center on River Bottom - Sign + Location form AT Heavy Gate
3. The bearings and distances in degrees and feet between claim corners and to a public land survey monument are as depicted on the map.
4. If the claim is a placer or millsite claim with exterior limits conforming to legal subdivisions of the public survey, provide a legal description of the claim W 1/4 SE 1/4 SE 1/4 R 29 T 8 N R 2 E

AMC 49127

Form MCF100a
Revised July 2014

This form is available from the Arizona Geology Survey and may be reproduced.

LOCATION NOTICE FOR PLACER MINING CLAIM

☐ Amendment BLM Serial # Amc449128

NOTICE IS HEREBY GIVEN that the fortitude
5 placer mining claim has been located by
Kelley Smelser whose current mailing
address is 3922 MARK TWAIN DR
PINETOP AZ 85935

BLM
Date
Stamp

RECEIVED
BLM STATE OFFICE
2018 MAR - 5 A 10:23
PHOENIX, ARIZONA

The general course of this claim is Placer and it is situated in YAVAPAI
County, Arizona. This claim is 1320 feet in length and 660 feet in width.

20 Total Claim Acreage. This claim runs from the location monument on which this location notice is
posted at the NE corner of the claim approximately 1320 feet in a S direction to the
SE end line and 660 feet in a W direction to the NW end line. This claim is
marked by four monuments, one at each corner of the claim.

The location monument on which this notice is posted is situated within Section 29, Township
8 N, Range 2 E, Gila Salt River Base and Meridian, Arizona. This claim encompasses
portions of the following legal subdivision(s) if located by legal subdivision or the following quarter section(s),
section(s), Township(s) and Range(s) W 1/4 NW 1/4 NE 1/4
S29 T8N R2E, Gila Salt River Base and Meridian, Arizona.

The locality of this claim with reference to some natural object or permanent monument and additional information
(if any) concerning its locality are as follows: Sign AM GATE OUT OF flooding
Area

_____ The above information is shown on the attached map.

DATED AND POSTED on the ground this 3 day of MARCH 2018.

☒ LOCATOR(s) ☐ AGENT

Print Name(s) Kelley Smelser

Signature(s) Kelley Smelser

Form MCF102
Revised July 2014

This form is available from the Arizona Geological Survey and may be reproduced.

Amc 449128

MINING CLAIM MAP

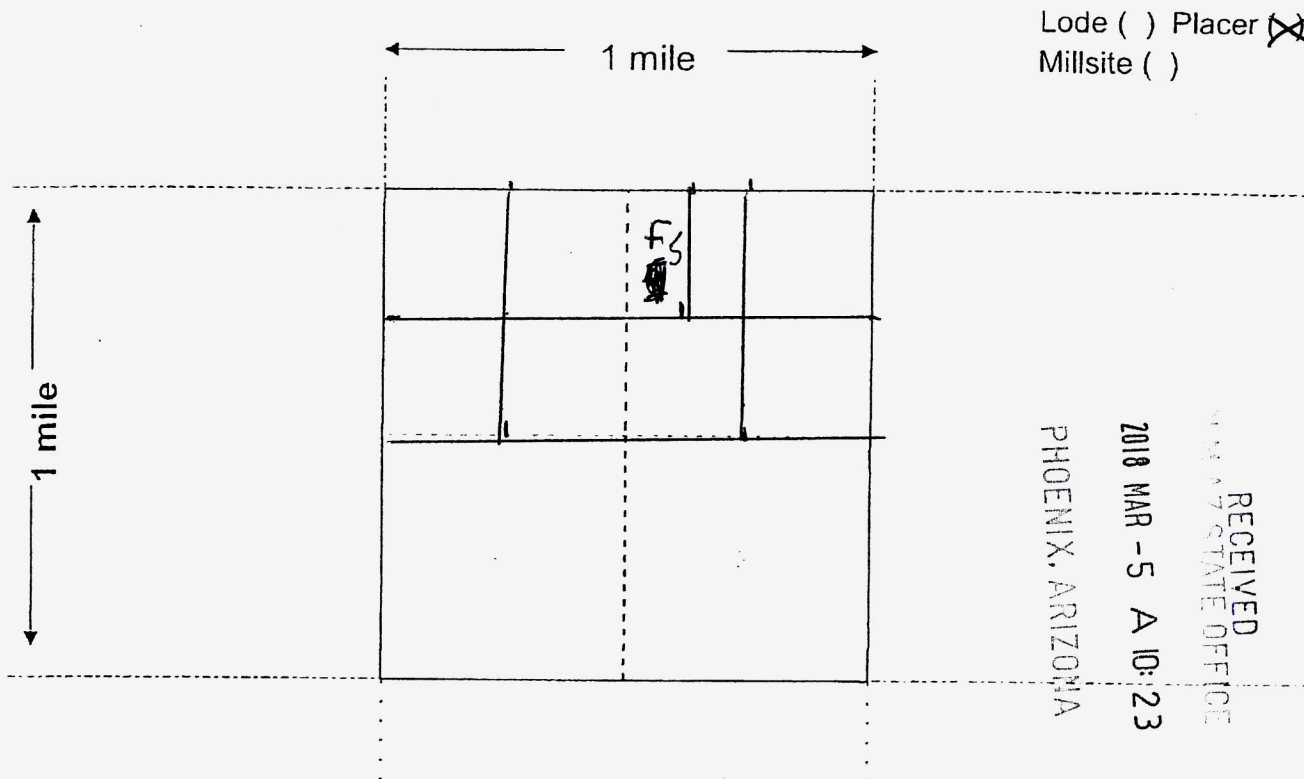

Scale: 1" = 2000 feet



- The above map depicts the fortitude #9 mining claim, which is located in Section (s) 29, Township 8 N, Range 2 E, Gila and Salt River Base and Meridian, YAVAPAI County, Arizona. Total claim acreage is 20
- The type of corner and location monuments used are as follows: ROCK monument
- The bearings and distances in degrees and feet between claim corners and to a public land survey monument are as depicted on the map.
- If the claim is a placer or millsite claim with exterior limits conforming to legal subdivisions of the public survey, provide a legal description of the claim W 1/4 NW 1/4 NE 1/4
S 29 T 8 N R 2 E

Form MCF100a
Revised July 2014

This form is available from the Arizona Geology Survey and may be reproduced.

Corrected copy of Location Notice

LOCATION NOTICE FOR PLACER MINING CLAIM

☐ Amendment BLM Serial # 449128

NOTICE IS HEREBY GIVEN that the Fortitude Hs

_____ placer mining claim has been located by

Kelly Smelser whose current mailing

address is 3422 MARK TWAIN DR

Pine Top AZ 85935

The general course of this claim is Placer and it is situated in YAVAPAI

County, Arizona. This claim is 320 feet in length and 660 feet in width.

20 Total Claim Acreage. This claim runs from the location monument on which this location notice is posted at the SE corner of the claim approximately 660 feet in a E direction to the SE end line and 1320 feet in a N direction to the NW end line. This claim is marked by four monuments, one at each corner of the claim.

The location monument on which this notice is posted is situated within Section 29, Township 8 N, Range 2 E, Gila Salt River Base and Meridian, Arizona. This claim encompasses portions of the following legal subdivision(s) if located by regular subdivision or the following quarter section(s),

section(s), Township(s) and Range(s) SE 1/4 SE 1/4 R 29
T 8 N R 2 E, Gila Salt River Base and Meridian, Arizona.

The locality of this claim with reference to some natural object or permanent monument and additional information (if any) concerning its locality are as follows: River Bank by Fourth of July

Deposit - Rock monument - Sign and Locator Paper
at Nearby Gate

The above information is shown on the attached map.
DATED AND POSTED on the ground this 22 day of February 2018.

☒ LOCATOR(s) ☐ AGENT

Print Name(s) Kelley Smelser

Signature(s) Kelly Smelser

BLM
Date
Stamp

RECEIVED
STATE OFFICE
2018 FEB 22 A 9:16
PHOENIX, ARIZONA

AMC 449128

RECEIVED
BLM
2018 APR - 9 P 3:16
PHOENIX, ARIZONA

Form MCF102
Revised July 2014

MINING CLAIM MAP

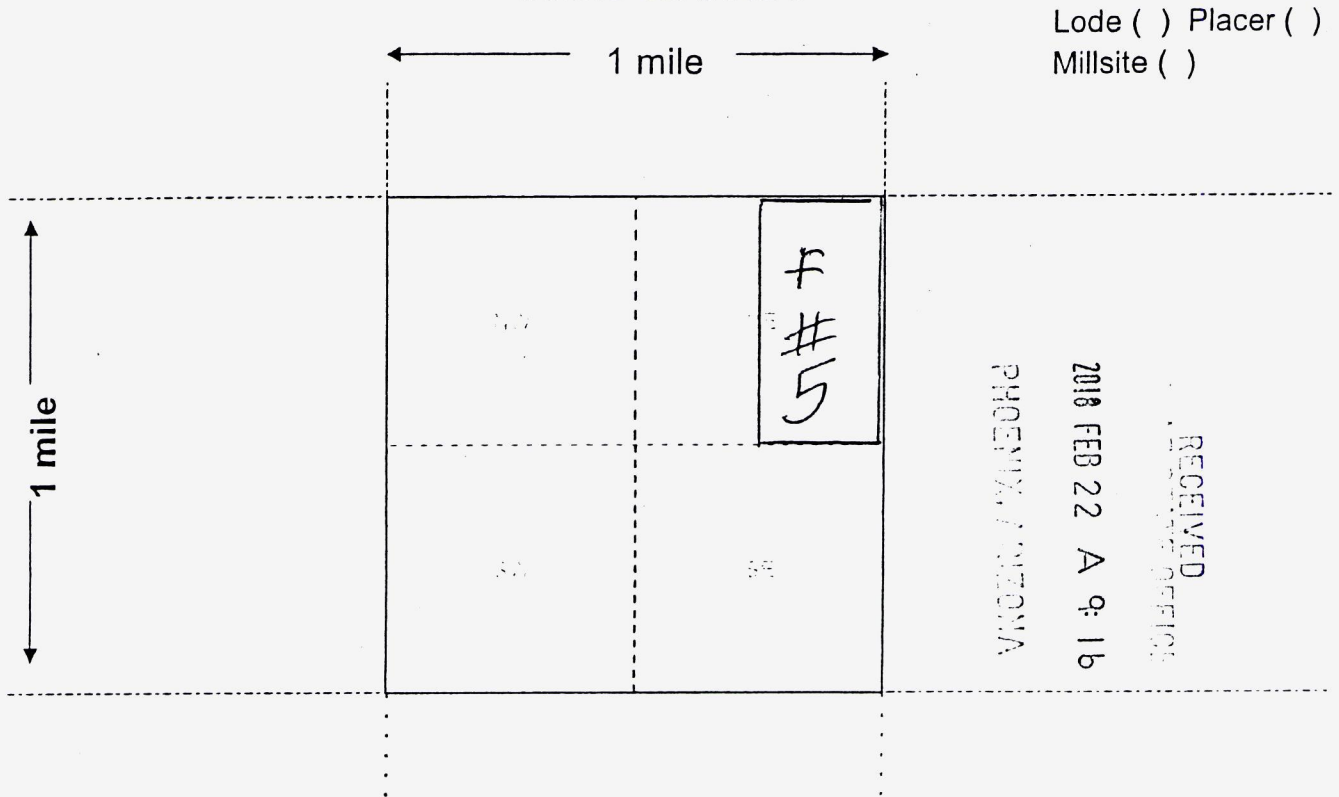

Scale: 1" = 2000 feet



1. The above map depicts the Fortitude #5 mining claim, which is located in Section (s) 29, Township 8 N, Range 2 E, Gila and Salt River Base and Meridian, Yavapai County, Arizona. Total claim acreage is 20

2. The type of corner and location monuments used are as follows: ROCK AT BASE OF CLIFF ABOVE ILKIN BOTTOM - SIGN + LOCATION FORM AT NEARBY CORNER

3. The bearings and distances in degrees and feet between claim corners and to a public land survey monument are as depicted on the map.

4. If the claim is a placer or millsite claim with exterior limits conforming to legal subdivisions of the public survey, provide a legal description of the claim E 1/2 NE 1/4 SE 1/4 T8N R2E

Form MCF100a
Revised July 2014

This form is available from the Arizona Geology Survey and may be reproduced.

AMC449128

PHOENIX, ARIZONA

2018 APR -9 P 5:13

☐ Amendment BLM Serial # 449120

NOTICE IS HEREBY GIVEN that the fortitude #s

_____ placer mining claim has been located by

Kellay Smelser whose current mailing
address is 3922 MARK TWAIN DR
PINETOP AZ 85935

The general course of this claim is Placer and it is situated in YAVAPAI County, Arizona. This claim is 1800 feet in length and 660 feet in width.

20 Total Claim Acreage. This claim runs from the location monument on which this location notice is posted at the SE corner of the claim approximately 660 feet in a E direction to the SE end line and 1320 feet in a N direction to the NW end line. This claim is marked by four monuments, one at each corner of the claim.

The location monument on which this notice is posted is situated within Section 29, Township 8 N, Range 2 E, Gila Salt River Base and Meridian, Arizona. This claim encompasses portions of the following legal subdivision(s) if located by legal subdivision or the following quarter section(s), section(s), Township(s) and Range(s) NE 1/4 SE 1/4 R 29
T 8 N R 2 E, Gila Salt River Base and Meridian, Arizona.

The locality of this claim with reference to some natural object or permanent monument and additional information (if any) concerning its locality are as follows: River bank by fourth of July
Deposit - Rock monument - Sign and locator paper
at nearby gate The above information is shown on the attached map.

DATED AND POSTED on the ground this _____ day of _____, 20_____

☒ LOCATOR(s) ☐ AGENT

Print Name(s)

Signature(s)

Form MCF102
Revised July 2014

This form is available from the **Arizona Geological Survey** and may be reproduced.

MINING CLAIM MAP

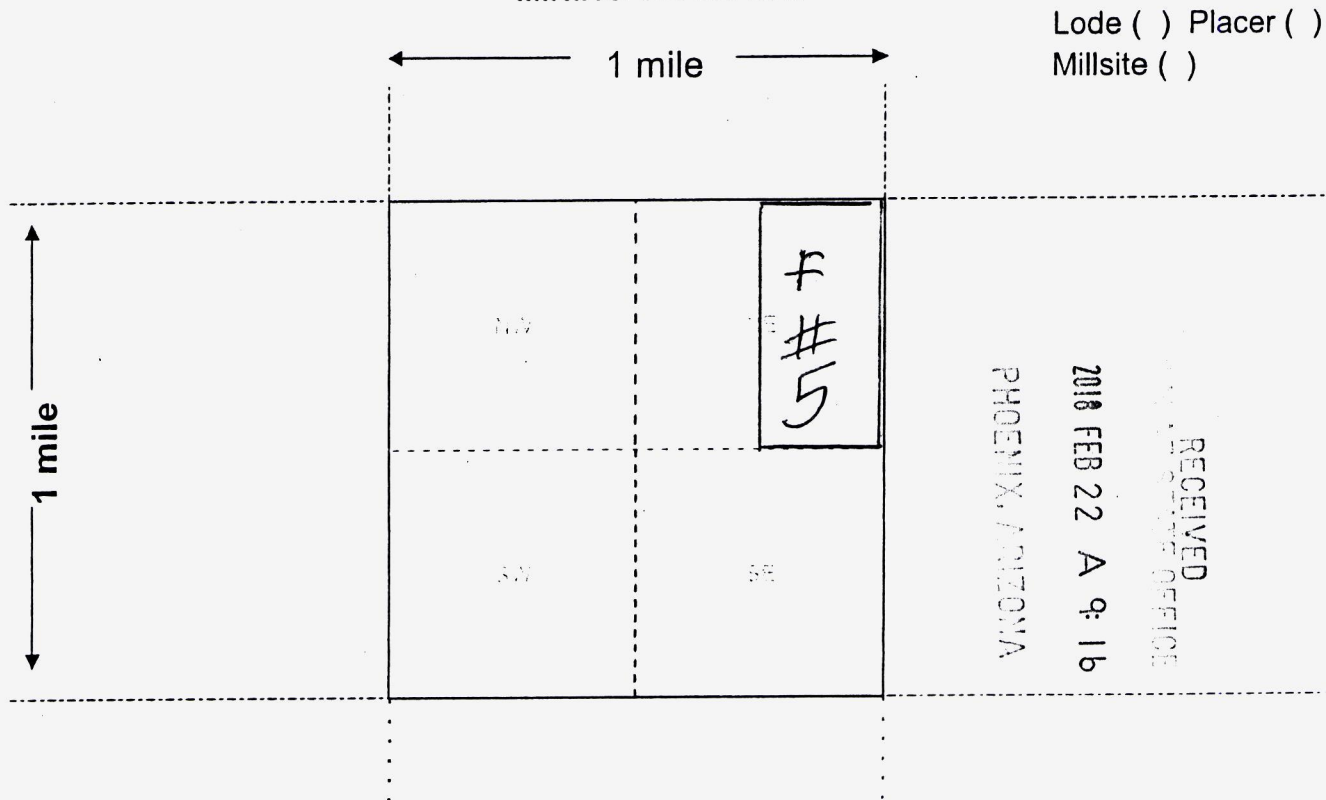

Scale: 1" = 2000 feet

1. The above map depicts the Fortitude #5 mining claim, which is located in Section (s) 29, Township 8 N, Range 2 E, Gila and Salt River Base and Meridian, YAVAPAI County, Arizona. Total claim acreage is 20

2. The type of corner and location monuments used are as follows: ROCK AT BASE OF CLIFF ABOVE RIVER BOTTOM - SIGN + LOCATION FORM AT NEARBY CORNER

3. The bearings and distances in degrees and feet between claim corners and to a public land survey monument are as depicted on the map.

4. If the claim is a placer or millsite claim with exterior limits conforming to legal subdivisions of the public survey, provide a legal description of the claim E 1/2 NE 1/4 SE 1/4 R 2 E T 8 N

Form MCF100a
Revised July 2014

This form is available from the Arizona Geology Survey and may be reproduced.

AMC449128

RUN TIME: 09:17 AM

DEPARTMENT OF INTERIOR
BUREAU OF LAND MANAGEMENT

RUN DATE: 02/22/2018
Page 1 of 1

Input Parameters for Geographic Report with Land

System Id = CR

Admin State = AZ

Geo State =

Casetype Begins With

Case Disp Txt = AUTHORIZED, CANCELLED, EXPIRED, PENDING, REJECTED, RELINQUISHED, VOID, WITHDRAWN

Mer Twp Rng = 14 0080N 0020E

Section = 029, 999

Mtrs =

Commodity =

Commodity Txt =

Pending Org =

Pend Org Decode =

Total Rows Returned: 11

NO WARRANTY IS MADE BY BLM FOR USE OF THE DATA
FOR PURPOSES NOT INTENDED BY BLM

RUN TIME: 09:17 AM

UNITED STATES DEPARTMENT OF INTERIOR
BUREAU OF LAND MANAGEMENT
GEOGRAPHIC REPORT WITH LAND
Sorted by Serial Number

RUN DATE: 02/22/2018

Page 1 of 2

Adm State: AZ

Serial Number: AZA 002936

Total Case Acres: 65,501.000

<u>Casetype</u>	<u>Case Disp</u>	14	0080N	0020E	<u>Sect</u>	<u>Sur Typ</u>	<u>Sur Num</u>	<u>Suff</u>	<u>Subdivision</u>	<u>Act Pend</u>
246100	AUTHORIZED				029	ALIQ			N2,SE;	

Serial Number: AZA 013912

Total Case Acres: 21.849

<u>Casetype</u>	<u>Case Disp</u>	14	0080N	0020E	<u>Sect</u>	<u>Sur Typ</u>	<u>Sur Num</u>	<u>Suff</u>	<u>Subdivision</u>	<u>Act Pend</u>
286203	AUTHORIZED				029	ALIQ			SE;	

Serial Number: AZA 030598

Total Case Acres: 1.000

<u>Casetype</u>	<u>Case Disp</u>	14	0080N	0020E	<u>Sect</u>	<u>Sur Typ</u>	<u>Sur Num</u>	<u>Suff</u>	<u>Subdivision</u>	<u>Act Pend</u>
293200	EXPIRED				029	FF		1	PORTION OF;	

Serial Number: AZA 031558

Total Case Acres: 1.000

<u>Casetype</u>	<u>Case Disp</u>	14	0080N	0020E	<u>Sect</u>	<u>Sur Typ</u>	<u>Sur Num</u>	<u>Suff</u>	<u>Subdivision</u>	<u>Act Pend</u>
293200	AUTHORIZED				029	FF			PORTIONS OF;	

Serial Number: AZA 031851

Total Case Acres: 1.000

<u>Casetype</u>	<u>Case Disp</u>	14	0080N	0020E	<u>Sect</u>	<u>Sur Typ</u>	<u>Sur Num</u>	<u>Suff</u>	<u>Subdivision</u>	<u>Act Pend</u>
293200	EXPIRED				029	FF			PORTION OF;	

Serial Number: AZA 032341

Total Case Acres: 1.000

<u>Casetype</u>	<u>Case Disp</u>	14	0080N	0020E	<u>Sect</u>	<u>Sur Typ</u>	<u>Sur Num</u>	<u>Suff</u>	<u>Subdivision</u>	<u>Act Pend</u>
-----------------	------------------	----	-------	-------	-------------	----------------	----------------	-------------	--------------------	-----------------

RUN TIME: 09:17 AM

UNITED STATES DEPARTMENT OF INTERIOR
BUREAU OF LAND MANAGEMENT
GEOGRAPHIC REPORT WITH LAND
Sorted by Serial Number

RUN DATE: 02/22/2018
Page 2 of 2

Adm State: AZ

293200 EXPIRED

029 FF

PORTION OF;

Serial Number: AZA 032498
Total Case Acres: 1.000

<u>Casetype</u>	<u>Case Disp</u>	<u>14</u>	<u>0080N</u>	<u>0020E</u>	<u>Sect</u>	<u>Sur Typ</u>	<u>Sur Num</u>	<u>Suff</u>	<u>Subdivision</u>	<u>Act Pend</u>
293200	EXPIRED				029	ALIQ			N2;	

Serial Number: AZA 033135
Total Case Acres: 1.000

<u>Casetype</u>	<u>Case Disp</u>	<u>14</u>	<u>0080N</u>	<u>0020E</u>	<u>Sect</u>	<u>Sur Typ</u>	<u>Sur Num</u>	<u>Suff</u>	<u>Subdivision</u>	<u>Act Pend</u>
293200	EXPIRED				029	FF			PORTION OF;	

Serial Number: AZA 033672
Total Case Acres: 1.000

<u>Casetype</u>	<u>Case Disp</u>	<u>14</u>	<u>0080N</u>	<u>0020E</u>	<u>Sect</u>	<u>Sur Typ</u>	<u>Sur Num</u>	<u>Suff</u>	<u>Subdivision</u>	<u>Act Pend</u>
293200	EXPIRED				029	FF			PORTION OF;	

Serial Number: AZA 034785
Total Case Acres: 1.000

<u>Casetype</u>	<u>Case Disp</u>	<u>14</u>	<u>0080N</u>	<u>0020E</u>	<u>Sect</u>	<u>Sur Typ</u>	<u>Sur Num</u>	<u>Suff</u>	<u>Subdivision</u>	<u>Act Pend</u>
293200	PENDING				029	FF			PORTION OF;	

Serial Number: AZA 036985
Total Case Acres: 1.000

<u>Casetype</u>	<u>Case Disp</u>	<u>14</u>	<u>0080N</u>	<u>0020E</u>	<u>Sect</u>	<u>Sur Typ</u>	<u>Sur Num</u>	<u>Suff</u>	<u>Subdivision</u>	<u>Act Pend</u>
293200	AUTHORIZED				029	ALL			ENTIRE SECTION	

YAVAPAI / MARICOPA COUNTY
HASSAYAMPA FIELD OFFICE

[illegible]

MDS 31 NE
32 NW
33 SW
34 SE

CURRENT TO	DSB	GSR Mer
1-16-2009	PV	T 8 N
		R 2 E

SCALE in chains

WARNING STATEMENT

This plot is the Bureau's Record of Title, and should be used only as a graphic display of the Township survey data. Records hereon do not reflect title changes which may have been effected by lateral movements of rivers or other bodies of water. Refer to the cadastral surveys for official survey information.